

SMA Inverter - System Reset

Before performing this reset check that your solar panels are clear of snow and that it is a sunny day – when you would expect your system to be producing power. If it is not a clear day, or if snow is on your system, please wait to do the reset until conditions allow for full production.

1. **Turn AC Disconnect Off** – Depending on your system set up this may be located near the inverter or in the main electrical service panel or subpanel.
 - a. If a stand-alone knife blade switch is present next to your inverter it should be labeled “AC Disconnect” (see example a below).
 - b. If it is in the electrical service panel or subpanel the dedicated breaker should be labeled “Solar” or “AC Disconnect” (see example b below).

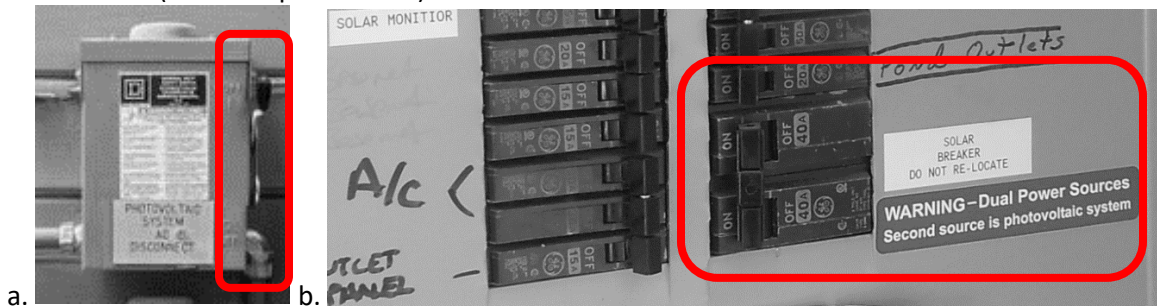

2. **Turn DC Disconnect Off** – This knob will be located underneath your inverter.
 - a. Rotate the DC-DISCO knob counter-clockwise from position "1" to the "0" position.

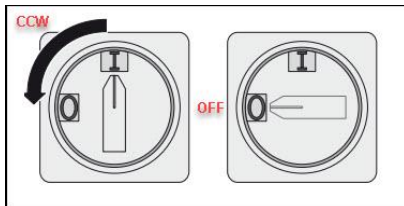

3. **Wait 5 minutes:** This wait time allows the inverter to discharge.
4. Turn the system back on:
 - a. **AC-ON First:** Turn the breaker (or knife blade switch) from step 1 back to the “on” position.
 - b. **DC-ON Next:** Move the DC-DISCO knob from step 2 clockwise from position "0" to the "1" position.
5. **Wait at least 5-15 minutes:** Depending on the model type and the error issue it can take up to 15 minutes for the inverter to fully power back “ON.”
 - a. *If you’re resetting an “Arc Detected” code, watch the inverter screen after reenergizing it. You should see a prompt to knock (as if you are knocking on a door) on the inverter to clear the code officially.*
6. If your solar system is functional, you should not see any errors on the inverter screen once the reboot is complete. If there are still error codes, please let our service team know what the error code is so we can schedule an appointment and come prepared to address the error.

Link to SMA’s instructions: https://my.sma-service.com/s/article/Preferred-Power-Cycle-for-SMA-US-Model-Inverters?language=en_US